

# Components

## Speaker Technology

### DT-300

Order No. 10.3860



#### Hi-fi dome tweeter, 50 W, 8 $\Omega$

- 30 mm silk cone
- Low resonant frequency
- Excellent dynamic response and a high stability, even with low crossovers
- Ferrofluid of high liquidity for a fine brilliance
- Particularly suitable for high-performance applications and D'Appolito arrangements in the top hi-fi range

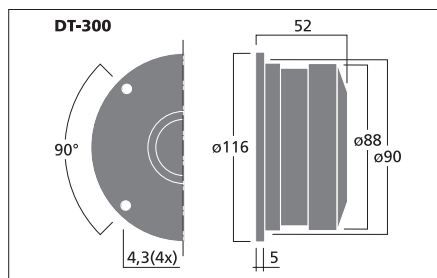

DT-300 (10.3860)

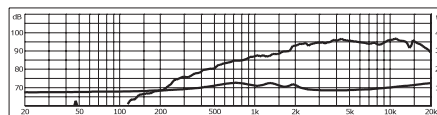

### WG-300

Order No. 11.0110

#### Special horn front attachment (wave guide)

- Increase in sound pressure
- Perfectly matched to dome tweeter DT-300
- For achieving consistent radiation pattern in combination with 15 cm to 25 cm (6-10") bass-midrange speakers
- For avoiding reflections from walls nearby
- For PA applications of specific room segments

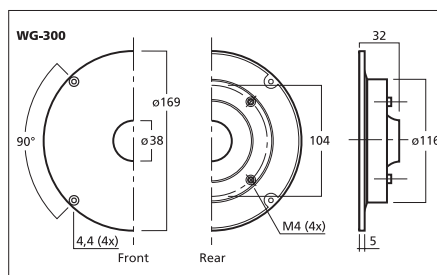

### DT-107

Order No. 10.2640



#### Hi-fi dome tweeter, 80 W, 8 $\Omega$

- Textile soft dome with inside damping
- Highest linearity with good efficiency
- Extra silky and brilliant sound
- For any hi-fi application of high requirements

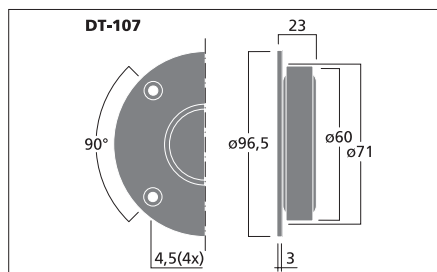

DT-107 (10.2640)

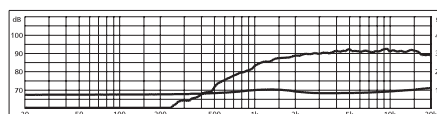

| Model                   | DT-300        | DT-107         |
|-------------------------|---------------|----------------|
| Impedance (Z)           | 8 $\Omega$    | 8 $\Omega$     |
| Frequency range         | fx-19,000 Hz  | fx-22,000 Hz   |
| Resonant frequency (fs) | 750 Hz        | 1,200 Hz       |
| Power rating            | 50 W          | 80 W           |
| Peak music power output | 100 W         | 130 W          |
| Sensitivity             | 93 dB/W/m     | 89 dB/W/m      |
| Voice coil diameter     | Ø 30 mm       | Ø 25 mm        |
| Mounting cutout         | Ø 90 mm       | Ø 71 mm        |
| Dimensions              | Ø 116 x 52 mm | Ø 96,5 x 23 mm |
| Weight                  | 0.65 kg       | 0.27 kg        |