

## DSM-48LAN

Order No. 0255770



SMART  
HOME  
READY

### Digital speaker management system

- 4 analogue inputs and 8 analogue outputs (XLR, balanced)
- 1 x AES/EBU digital input, stereo
- 64-bit DSP, sampling rate: 96 kHz
- Dynamic range: > 118 dB
- Latency: 0.64 ms
- 80 user presets can be stored
- Remote control via USB or TCP/IP LAN, iOS app
- Dot matrix display with 2 x 16 characters
- 482 mm (19") rack installation, 1 RS

### Input (data for each channel)

- Gain control: -48 dB to +12 dB
- 10 parametric equalizers with 8 types of filters each
- 2 crossover networks
- Delay
- Limiter threshold: from -48 dBu to +24 dBu
- Compressor release time: 10 dB/s to 100 dB/s
- Mute



### Output (data for each channel)

- Gain control: -48 dB to +12 dB
- 10 parametric equalizers with 8 types of filters each
- 2 crossover networks
- Delay
- Limiter threshold: from -48 dBu to +24 dBu
- Compressor release time: 10 dB/s to 100 dB/s
- Mute
- Routing mix for level adjustment via routing fader
- Selectable phase (invert, 180°)

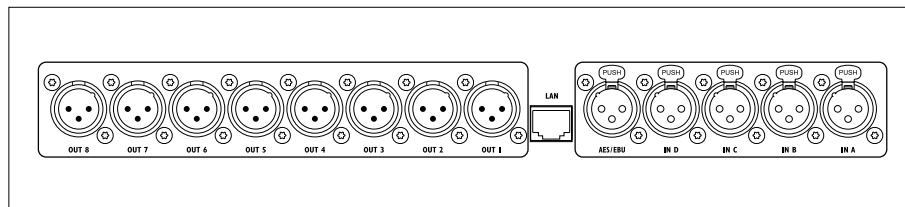

Model	DSM-48LAN
Frequency range	10-40,000 Hz
Input signal	11 V max.
Output signal	4 V max.
S/N ratio	> 110 dB
THD	< 0.005%
Power supply	230 V~/50 Hz/15 VA
Dimensions	482 x 44 x 185 mm, 1 RS
Weight	2.17 kg

## DSM-26LAN

Order No. 0255760



SMART  
HOME  
READY

### Digital speaker management system

- 2 analogue inputs and 6 analogue outputs (XLR, balanced)
- 1 x AES/EBU digital input, stereo
- 64-bit DSP, sampling rate: 96 kHz
- Dynamic range: > 118 dB
- Latency: 0.64 ms
- 80 user presets can be stored
- Remote control via USB or TCP/IP LAN, iOS app
- Dot matrix display with 2 x 16 characters
- VU meter with 4 LEDs for each channel, level display and peak
- 482 mm (19") rack installation, 1 RS

### Input (data for each channel)

- Gain control: -48 dB to +12 dB
- 10 parametric equalizers with 8 types of filters each
- 2 crossover networks
- Delay
- Limiter threshold: from -48 dBu to +24 dBu
- Compressor release time: 10 dB/s to 100 dB/s
- Mute



### Output (data for each channel)

- Gain control: -48 dB to +12 dB
- 10 parametric equalizers with 8 types of filters each
- 2 crossover networks
- Delay
- Limiter threshold: from -48 dBu to +24 dBu
- Compressor release time: 10 dB/s to 100 dB/s
- Mute
- Routing mix for level adjustment via routing fader
- Selectable phase (invert, 180°)

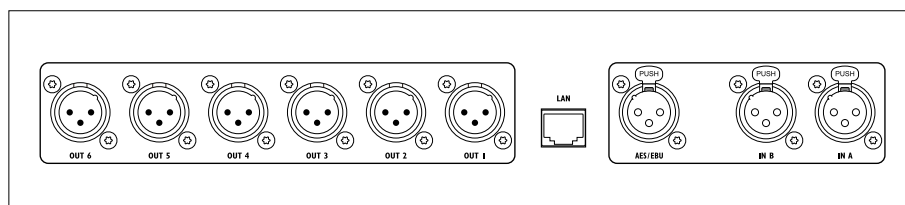

Model	DSM-26LAN
Frequency range	10-40,000 Hz
Input signal	11 V max.
Output signal	4 V max.
S/N ratio	> 110 dB
THD	< 0.005%
Power supply	~ 230 V/50 Hz/15 VA
Dimensions	482 x 44 x 185 mm, 1 RS
Weight	2.13 kg